

# THE SANCTUARY AT GOOD HOPE EAST

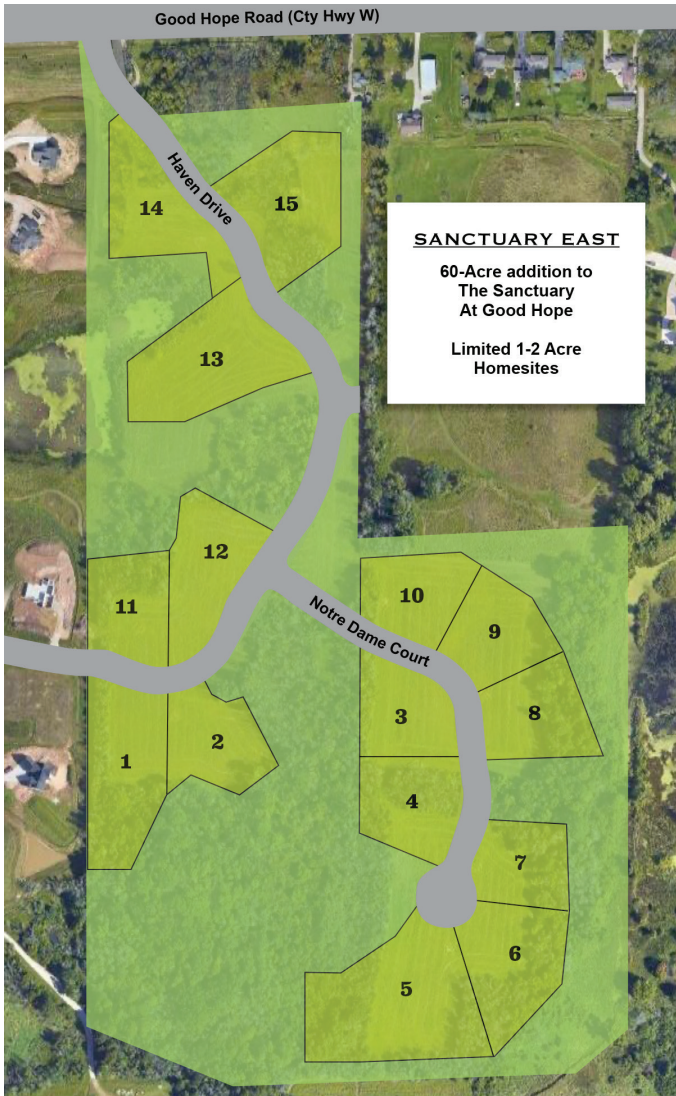

## About the Community

The Sanctuary at Good Hope is a premier conservation subdivision in the heart of Menomonee Falls. The new addition, Sanctuary East, offers fifteen 1-2 acre home sites, spread over 150 acres. Most lots have the ability to offer varying levels of exposure, depending on your preference. The Sanctuary offers residents miles of natural walking trails and more than 70 acres of natural conservancy land.

The Village of Menomonee Falls offers unparalleled amenities, recreation, and short commute times - it's just 20 minutes from downtown Milwaukee. The Sanctuary is located in the coveted Sussex Hamilton School District.

## Neighborhood Features

- 26 Estate-sized homesites
- Country setting in a suburban paradise
- Lot size: 1-2 Acres
- Protective covenants
- Private mound system & well
- Sussex Hamilton School District

## Directions

I-94, exit County Hwy F/Redford Blvd. North to Hwy K/Lisbon Rd. Turn tight and follow Lisbon Rd. to Lannon Rd./County Hwy Y. Left on Y/Lannon Rd. Right (east) onto Good Hope Rd. To subdivision entrance on the right.

*Information is deemed to be accurate and is subject to change without notice. Buyers are encouraged to review the recorded plat map and grading plans with their builder. Please call for current availability.*

