

EST.  2023

ST. JOHN'S ESTATES

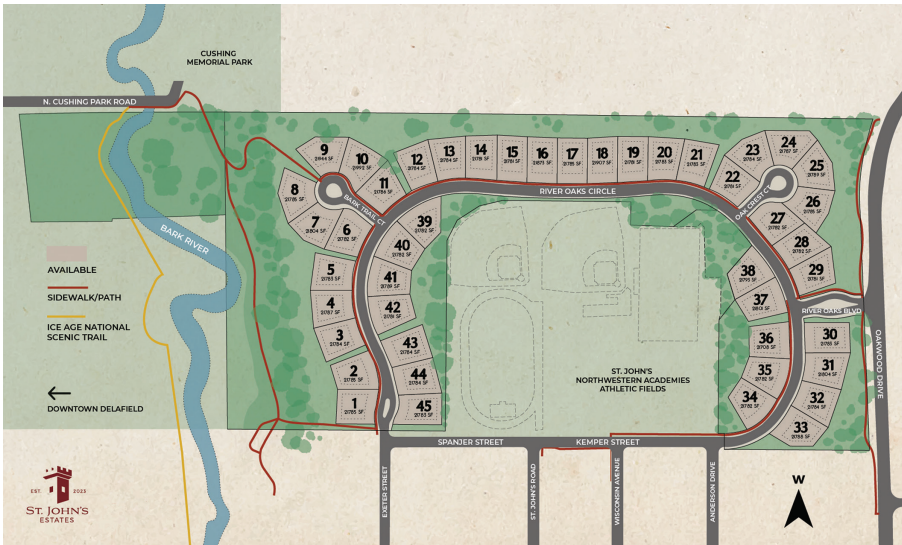

About the Community

Located in Delafield and built on St. John's Northwestern Golf Course, this subdivision preserves existing landscapes while integrating brand new features for the residents' benefit. Residents will enjoy the professionally landscaped space with carefully selected trees, shrubs, and perennials, as well as three rain gardens throughout. Scenic walking trails lead to outdoor landmarks such as the Ice Age National Scenic Trail and Cushing Memorial Park, which features a playground for kids and a recently renovated pier. Down the road from St. John's Estates you will find Nagawicka Lake with a resident-only boat launch. It's also a short drive from Lapham Peak State Park, a popular spot for runners, hikers, mountain bikers, and dog walkers alike!

St. John's Estates consists of 45 half-acre lots within the Kettle Moraine School District and just outside Downtown Delafield, putting you within walking distance of the area's ample shopping and dining options. Enjoy easy access to cafes, salons, bookstores, and more while maintaining a quiet area of your own with this subdivision's two private entrances. Delafield is also home to popular community events such as the Delafield Block Party, Lake County Art Festival, Delafield Car Show, and plenty of others for wherever your interests lie. Whether you need a place to take the dog for a stroll or want to find your new favorite coffee shop, St. John's Estates is sure to fit your lifestyle!

Directions

From I-94 W, take exit 285 for County Road C toward Delafield and head north onto N Genesee Street. Turn left onto Oakwood Road, and St. John's Estates will be on the right.

Neighborhood Features

- 45 Half-acre single family home site
- Sanitary sewer system
- Protective covenants
- Nearby nature trails and rivers
- Walking distance to downtown Delafield
- Kettle Moraine School District

Information is deemed to be accurate and is subject to change without notice. Buyers are encouraged to review the recorded plat map and grading plans with their builder. Please call for current availability.



FOLLOW US ON:



allanbuilders.com 866-569-2500
victoryhomesofwisconsin.com 866-252-7100