



KOHLER RIDGE

In the City of New Berlin

About the Community

- 47 Homesites ranging from 3/4 acre to over an acre
- 3 miles of walking trails, private pond and fishing pier
- Spectacular views
- New Berlin Schools (New Berlin West High School)

This premier subdivision features 47 exclusive home sites set among an abundance of permanent open space conservancy. Creative land planning provides for many lots with an exposed lower level option, and most are adjacent to natural open space that will provide for spectacular views. Estate size lots range in size from 3/4 to over an acre.

Enjoy the serenity of the natural scenic countryside and amenities that will be exclusive to Kohler Ridge, such as 3 miles of walking trails, private pond, and pier for fishing and viewing deck. Conveniently located in the south west edge of New Berlin and just minutes from I-43 and the heart of New Berlin, Muskego and Waukesha.

Directions: I-43 exit Racine Ave. (Hwy Y). North to Lawnsdale Rd. West to subdivision entrance.

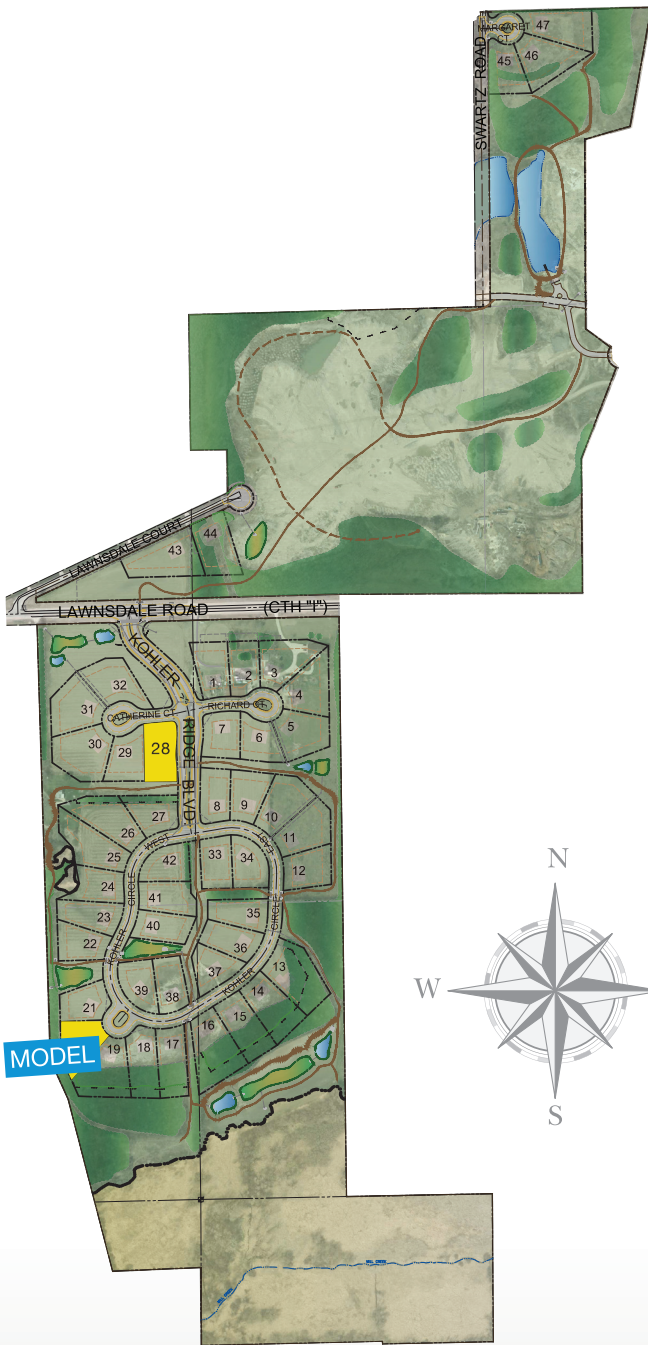

Lot	Lot Size	Exposure	List Price	Availability
20	35,833	Walk-out	\$184,900	Victory Homes Model Coming Soon
28	36,195	Look-out	\$151,900	Available



allanbuilders.com
866-569-2500



victoryhomesofwisconsin.com
866-705-7000